

Thank you for purchasing our PSA Centrii Floodlight Camera (Model: CENFLCAM2-B)

This Guide shows how to pair the Floodlight Camera to the free PSA Centrii mobile App. It also shows how to share your App access with other users (eg. household members).

Important: Ensure a strong 2.4GHz Wi-Fi signal is available at the Floodlight Camera mounting location. Also, confirm your Wi-Fi modem/router is ONLINE to the Internet.

Step 1

Download the PSA Centrii App

- Download "PSA Centrii" App from the Apple App Store, or Google Play Store.
- Tap the PSA Centrii app icon to start the mobile app.
- Register a free account with your Email address.



Step 2

Turn On the Floodlight Camera

- Power on the Floodlight Camera.
- Wait for the Red LED to blink quickly.

Tip: If you do not see a blinking red LED, then press its reset button (back of camera module) for 5 seconds to reset the unit. Allow several minutes for the Floodlight to reboot.

Step 3

Pairing with the PSA Centrii App

- On your mobilephone, temporarily turn **Airplane Mode to ON** (with Mobile Data to OFF). Then re-enable the Wi-Fi function only on your phone.
- the PSA Centrii App, tap **"Add Device"**. (Figure 2)
- In the left column, tap **"Security"**. Then tap the **"PSA Centrii Floodlight Camera"** icon. (Figure 3)

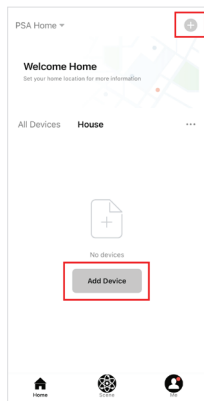

Figure 2. Add Device

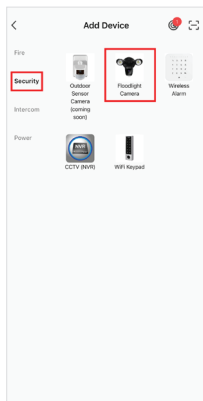

Figure 3. Select Product

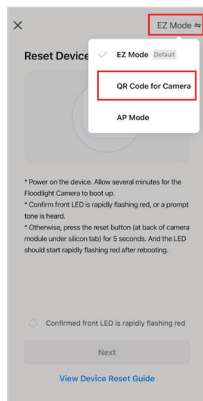

Figure 4. EZ Mode

- If **"EZ Mode"** is shown on top right of App screen. Tap it to change to **"QR Code for Camera"**. (Figure 4)
- Tap **"Confirmed front LED is rapidly flashing red"**
- Then tap **"Next"**.
- Enter the login details of your local 2.4GHz Wi-Fi network, together with its password. (Figure 5). Tap "Next" to continue.
- Present the QR Code on your phone screen to the Floodlight Camera (lower module). Move your phone back & forth slowly in front of Floodlight Camera.
- Tap "I heard a prompt" to continue.
- Wait for the App to complete pairing and registering the Floodlight Camera. (Figure 6)
- The App will report "Device added successfully". Tap **"Done"** to acknowledge. (Figure 7)

Tip 1: The Floodlight Camera LED should have turned solid Blue.

Tip 2: Tap the Pencil icon to rename the device.

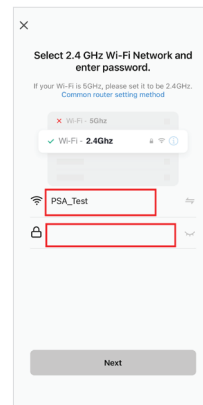

Figure 5. WiFi Login

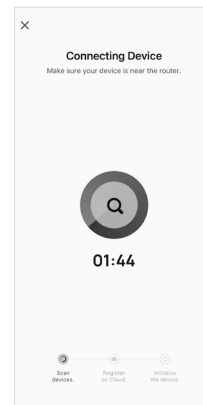

Figure 6. Pairing

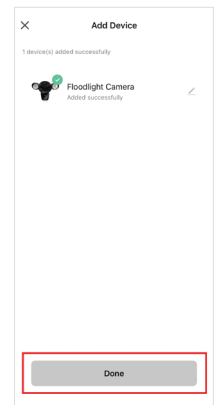

Figure 7. Success!

Congratulations, your phone App is now paired with the PSA Centrii Floodlight Camera.

Tip: Tap the "Security Camera" icon on the main page to enter LiveView.

If the App fails to pair with Device:

- Split your Wi-Fi bands to create a distinct SSID for the 2.4GHz band (e.g. "YourWiFi_24GHz"). Turn off "Band Steering".
- Turn off WPA3 Wi-Fi Encryption. Most of our devices can currently only use WPA2 Encryption.
- Perform a speed test on your 2.4GHz Wi-Fi band, next to your Floodlight. A minimum Upload Speed of 2Mbps is required."

Sharing Access of Floodlight Camera

Your Floodlight Camera can be accessed by other users; by sharing the device with them (eg. other household members).

Sharing can only be setup by the primary (original) login account.

Step 1

Create New User Accounts

- Install the PSA Centrii App into the smartphones of each user.
- Create a new User Account for every user to receive sharing. Tap **"Register"** to begin, & follow the App prompts.

Each user will need a unique email address as their App account ID.

Preparing To Share

- Login to your primary PSA Centrii App account.



- Enter the preregistered Login (email address) of a new member (from Step 1) into the 'Account' field. Also enter a Name (of your choice) to identify this member.
- Select the sharing permission for this user (either as default **"Common Member"**, or **"Administrator"** with full rights).
- Tap **"Save"** (topright corner) to confirm.
- The App will list the new shared user, but with a pending message **"Waiting to join ..."**

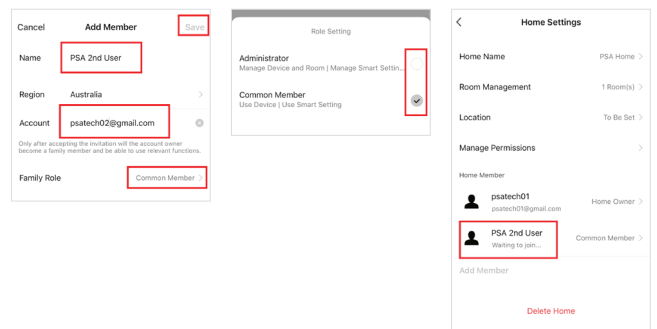

Step 2

- On the Main page of the PSA Centrii app, tap the **"Me"** icon on the bottom right corner. Then tap **"Home Management"**
- Tap **"Create a Home"**. Complete the new **"Home Name"** field. Then tap **"Save"** at top-right corner. (In this example, "PSA Home" is the Home Name)
- Tap your new Home name (e.g. "PSA Home").
- Tap **"Add Member"** to share with another user.
- Tap the **"App Account"** icon.

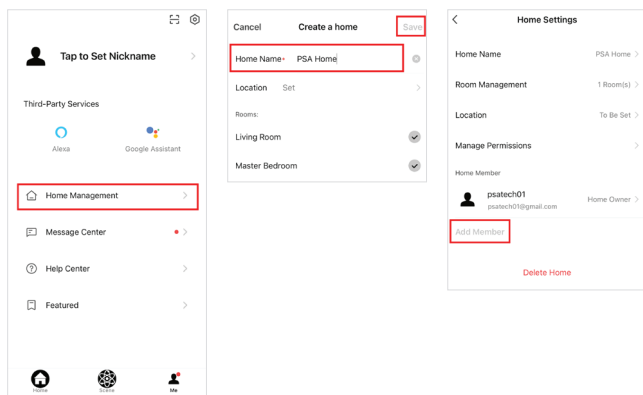

Step 3

Accept Shared Device

To complete the sharing process, the other user must accept the share invitation through their account login.

- On the other user's phone, log into their PSA Centrii app account.
- Tap **"Me"**, then **"Home Management"**. Look for an invitation message (**"Waiting to join.."**). Tap it to select.
- Tap **"Accept"** to confirm invitation.
- Tap **"Home"** to return to the Main Page.
- Tap top left corner to switch to the newly accepted Home. All PSA Centrii devices linked to this new Home will appear in their account.
- Repeat the above Steps 2 to 4 to add more shared users.

