

## Quick Setup Guide

# Centrii NVR

(for 8 & 16-channel NVR)

Welcome to your new PSA Centrii CCTV system with the 8 or 16-channel NVR.

This Quick Setup Guide takes you through the initial setup of your PSA Centrii NVR console.

It also prepares the NVR for remote access by your PSA Centrii App.

### Step 1 Device Installation

Plug all available cameras into the rear PoE camera ports.

Connect a CAT5 / CAT6 Ethernet cable between the LAN port of the NVR and your modem. Ensure your modem/router is ONLINE and connected to the Internet.

Connect a HDMI cable between the NVR and a TV/Monitor HDMI-input.

Connect the power cable from the supplied power supply to the "DC 48V" socket. Turn the power switch ON.

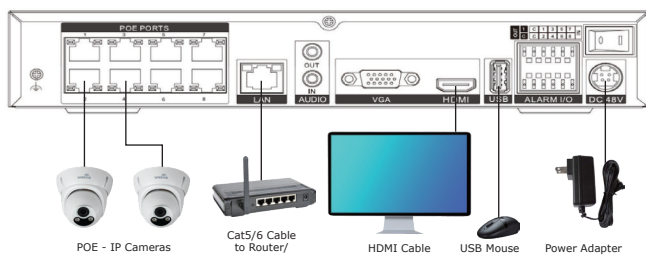

### Step 2 System Password

- Enter your preferred login Password for your NVR. Please observe the password rules as shown on screen.

**Tip:** Click the eyelid-icon to reveal your Password.

- Re-enter the Password to confirm.
- Click "OK" when done.

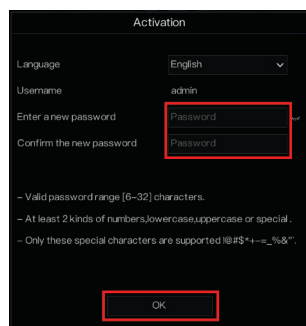

### Step 3 Unlock Pattern

- Draw an Unlock Pattern by connecting at least two dots. (This pattern allows quick login without typing in the Password)
- Re-draw the Unlock Pattern to confirm. Click "OK" to continue.

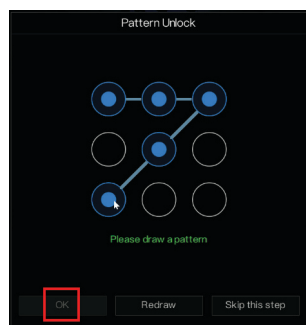

### Step 4 Password Recovery Email

- Enter an optional Email Address for recovery passwords to be sent to.  
(This feature allows a lost password to be quickly reset)  
(Or click "Skip This Step" to bypass this feature)
- Click "OK" when done.
- Complete the three Security Questions.
- Click "OK" when done.

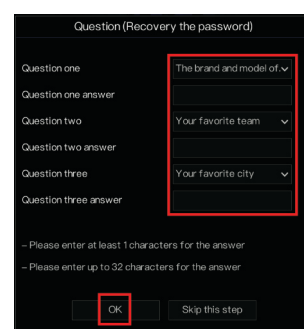
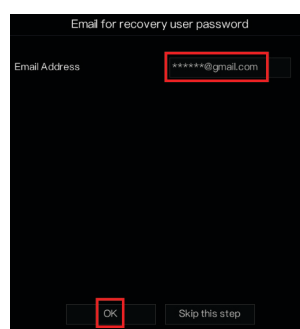

### Step 5 Setup Wizard

- Click "Setup Wizard" to continue with general setup.

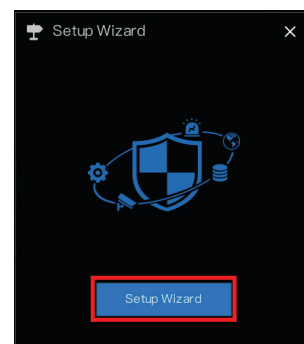

### Step 6 Network Setup

- Confirm the "DHCP" switch is turned On (blue)
- Confirm "Obtain DNS Automatically" is On (blue)
- Click "Next" to continue.

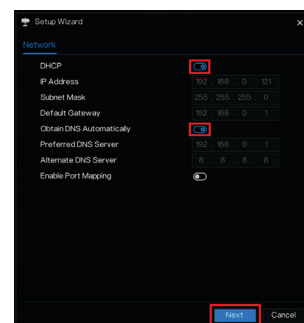

## Step 7 Date & Time

- Confirm **"Enable NTP"** is On (blue). This allows automatic time synchronisation via the Internet.
- Click on **"Time Zone"** tab. Then click the downward arrow to select your time zone.
- Click **"Next"** when done.

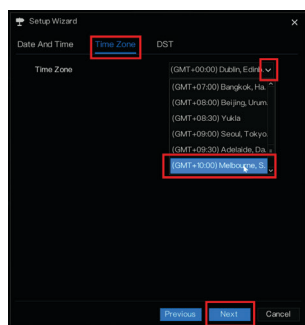
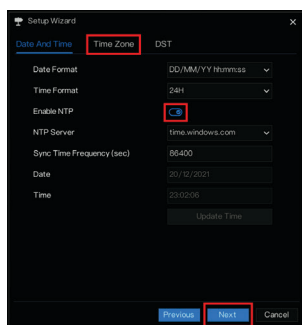

## Step 8 Cameras

- By now, all the cameras may already be visible in the background LiveView screen.
- Otherwise, click **"Start Search"** to look for available cameras.
- When all cameras are listed, click **"Next"** to continue.

**Tip:** The default camera activation password ("admin") is revealed by clicking the nearby "eye"-icon.

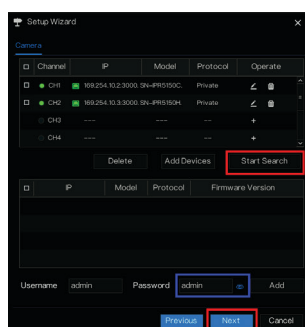

## Step 9 Initialise Hard Drive

- Click the checkbox in leftmost column to select Hard Drive to format.
  - Click **"Format"** to initialise Hard Drive.
  - Click **"OK"** to confirm.
- Warning:** This action will wipe all previously stored content in the Hard Drive.
- Click **"OK"** to continue.

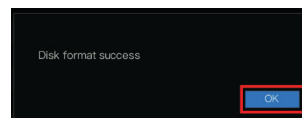
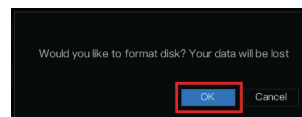
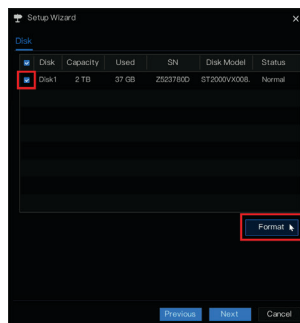

## Step 10 Display Resolution

- Confirm the display resolution as default 1920 x 1080 pixels.
- Warning:** Incompatible display resolutions will cause the display to blank out.
- Click **"Finish"** to exit setup Wizard.

=====

**Congratulations! You have successfully setup of your new PSA Centrii NVR.**

