

PSA

Centrii

Solar Wireless PT Cam (Pan & Tilt)

Quick Setup Guide



Model:
CENSLPTCAM

Welcome

Dear Customer,

Thank you for choosing a PSA security product.

There are 3 things you should know before using this product:

1. Micro SD Card

A micro SD card (not included) can be inserted into the product for local recording storage. The card must be formatted before use.

2. Select 2.4GHz Wi-Fi

The product only supports 2.4GHz Wi-Fi, please select 2.4GHz Wi-Fi when setting up the app.

3. Select installation location.

Please use your mobile phone to test the coverage of the home Wi-Fi signal at the planned installation position before installation, so that the product can receive a better signal.

For product support, please visit our website for more information. Or contact us through one of the following ways:

phone: Australia: 1300 772 776

email: support@psaproducts.com.au

web: psaproducts.com.au

socials: @psaproducts

Table Of Contents

Kit Contents	3
Product Overview	4
Setting Up the System	5
Installation	8
Warranty & Liability	14
Specifications	15

Kit Contents

Solar Camera

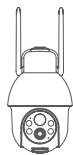

Camera

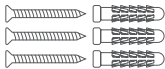

Screw Pack

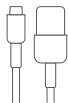

USB-C Charging Cable



Position Sticker



Security Sticker



Quick Start Guide

Solar Panel



Solar Panel



Universal Joint



Socket nut



Locking Screw Cap



Base

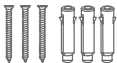

Mounting Screws and Anchors

Product overview

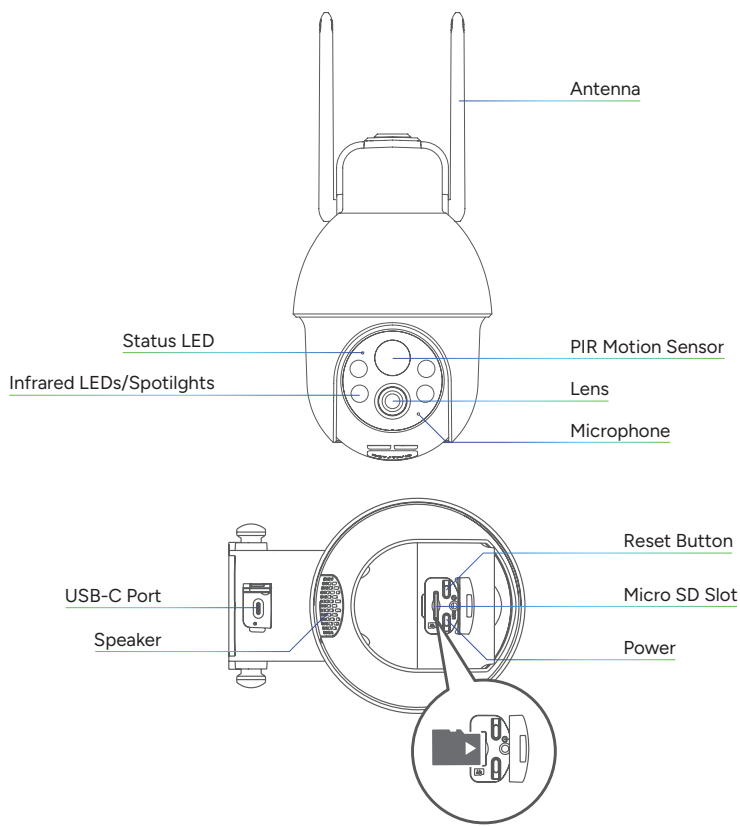

CAUTION	Please insert the Micro SD Card according to the direction shown in the diagram. Micro SD Card might JAM if inserted incorrectly and device could be damaged.
Micro SD Card Port	Support Micro SD Card for local storage (Max 512GB).
Reset button	Press and hold the button for 3 seconds, and then the device will be ready to be connected.
Card capacity requirements	8-512GB.
Read and write speed requirements	class10 level.
File format	FAT32.

Setting Up the System

Download the "PSA Centrii App from the App Store (iOS devices) or Google Play (Android devices).



Preparing the PSA Centrii Camera for Connection

1. Turn on the Security Camera by pressing its Power button for 10 seconds.
(If the internal battery is discharged, then plug USB power into its USB-C socket)
2. Allow several minutes for the Camera to boot up.
3. Confirm its LED is flashing BLUE.
 - * Otherwise, press and hold its Reset button for 6 seconds to reset it.
 - * Wait until its LED is flashing BLUE.

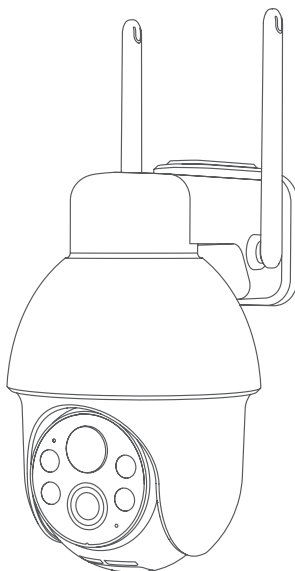

Pairing Camera to PSA Centrii App

Start the PSA Centrii app. Tap "Sign up" to register a new app account (or log into the App).

1. On your mobile phone, temporarily turn Airplane Mode to ON (with Mobile Data to OFF). Then re-enable the Wi-Fi function only on your phone.
2. On the PSA Centrii App, tap "Add Device". (Figure 1)
3. In the left column, tap "Security". Then tap the "Security Camera" icon. (Figure 2)
4. Confirm "QR Code for Camera" is shown on top right of App screen. Otherwise, tap it to change selection. (Figure 3)
5. Tap "Confirmed the Camera is blinking Blue"



Figure 1

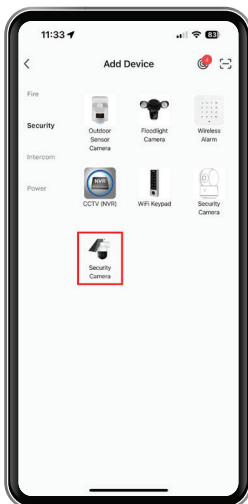

Figure 2



Figure 3

6. Then tap "Next".
7. Enter the login details of your local 2.4GHz Wi-Fi network, together with its password. (Figure 4). Tap "Next" to continue.
8. Present the QR Code on your phone screen to the Camera. Move your phone back & forth slowly in front of Camera until you hear a tone.
9. Tap "I heard a prompt" to continue.
10. Wait for the App to complete pairing and registering the Camera. (Figure 5)
11. The App will report "Device added successfully". Tap "Done" to acknowledge. (Figure 6)

Tip 1: The Camera LED should have turned solid Blue.



Figure 4

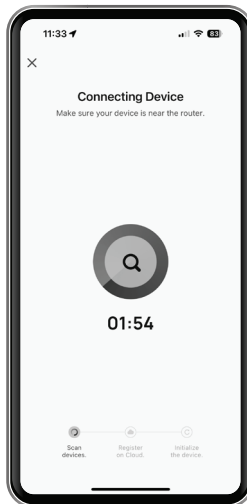

Figure 5

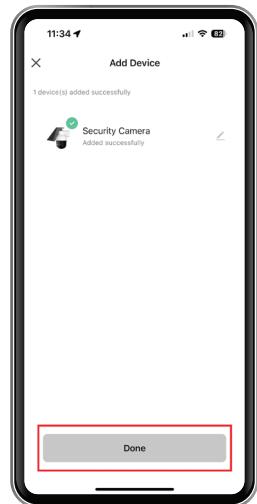

Figure 6

Congratulations, your phone App is now paired with the Security Camera.

Installation

Find a Good Mounting Spot

To find a spot to mount Camera, you need to test wireless signal strength.

One method is to connect your phone to your 2.4GHz Wi-Fi signal. Then position your phone at where you want to mount the camera. And observe the number of Wi-Fi signal strength bars shown on your phone.

If necessary, move the camera closer to the Wi-Fi router for a better signal. Or add Wi-Fi extenders to improve the 2.4GHz Wi-Fi signal.

Select Height and location

Hang the Camera 2-3 meters above the ground. This height maximises the detection range of the motion sensor of Camera. Avoid placing Camera under direct sunlight.

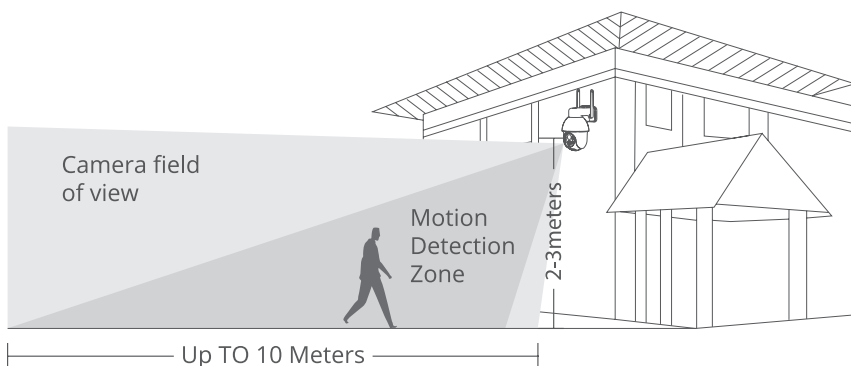

Installation instruction of solar panel

1. Keep the installation angle of solar panels about 30-45° with the horizontal plane, as shown in the picture below.
2. The installation between the solar panel and the camera is shown in the following figure (open up the silicone cover at the bottom of the camera, remove the small center part of the cover, insert the power cord through the opening and plug it into the USB-C Port and then close the cover taking up any slack in the power cord from the solar panel).

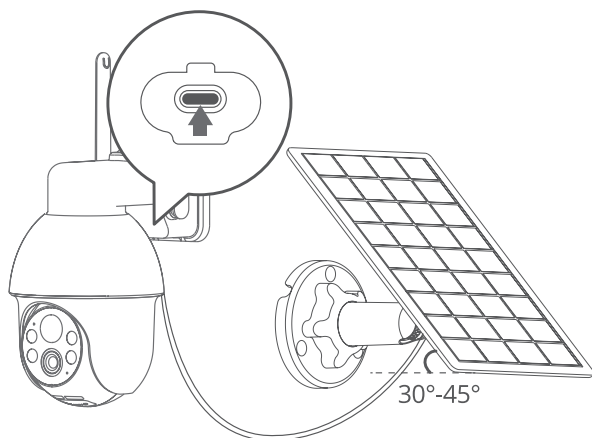

Tips for the installation of solar panel

1. When installing in the northern hemisphere, face the panel to the south, and when installing in the southern hemisphere, face the panel to the north.
2. Take care to install the solar panel so that the sun is not blocked by any items such as eaves, trees branches, etc.

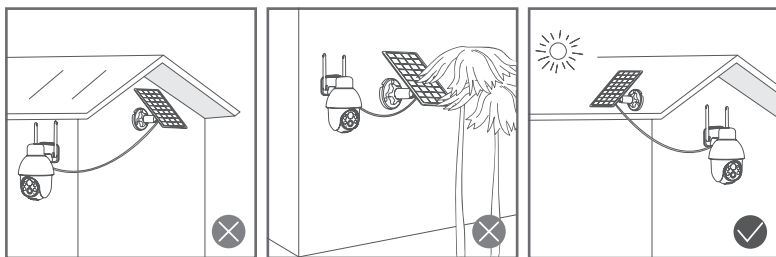

Test the Wi-Fi signal at installation position

Use your mobile phone to test Wi-Fi signal quality at the installation position before installing camera, make sure the Wi-Fi router can provide good Wi-Fi signal.

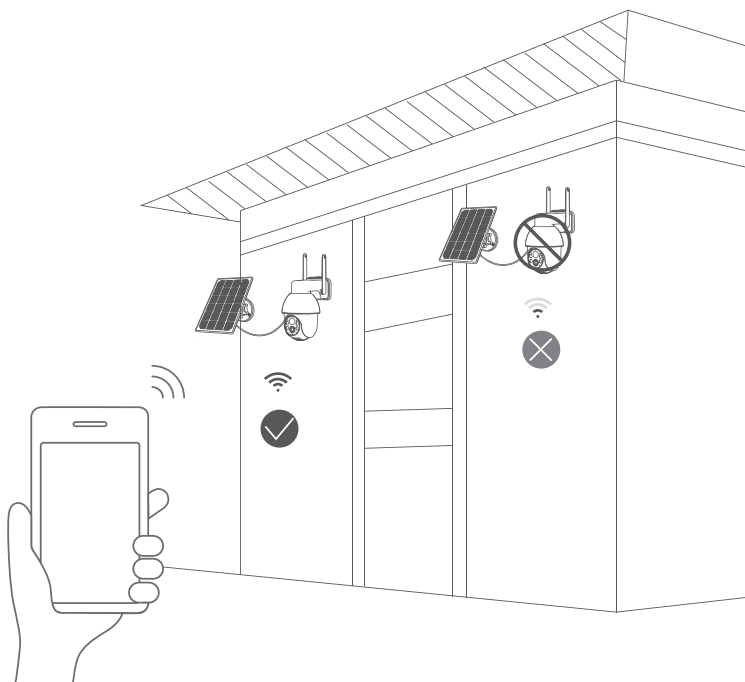

Installation

1. Drilling according to position sticker, drill bit: 15/64"(6 mm).
2. Insert the plugs.
3. Tighten the screws.

What is required:

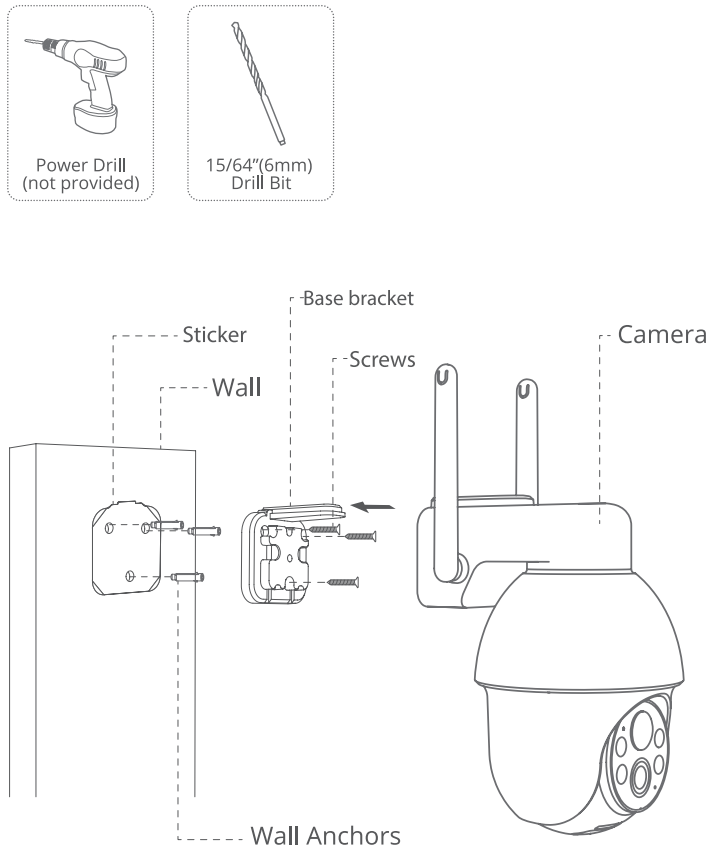

Installation instruction of solar panel

Place Solar Panel in an area with consistent sunlight throughout the year. It only needs a few hours of direct sunlight each day to keep your camera powered.

The amount of energy that the solar panel produces is affected by weather conditions, seasonal changes, geographic location, etc.

1. Fix the base to your mounting location using the included screws. If the installation surface is soft or unstable, first use a drill bit to drill a hole in the wall, then insert the anchor nail into the hole, and fix the base with screws.

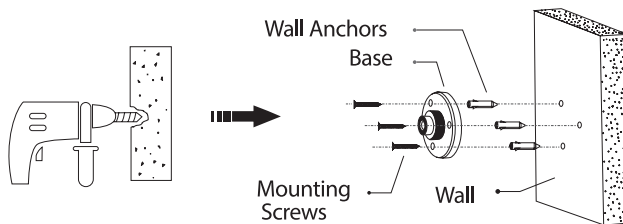

2. First, install the locking screw cap into the universal joint and then screw the circular socket nut into the universal joint.

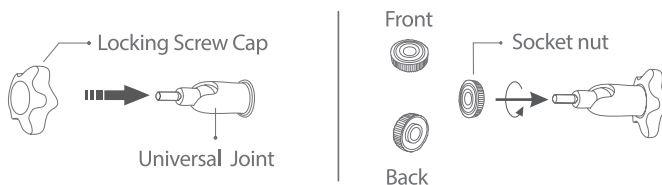

3. Screw the universal joint into the back of the solar panel. Tighten it firmly with the attached nut.

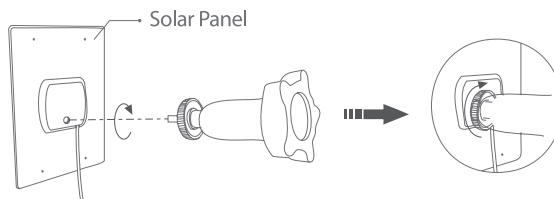

4. Screw the locking screw cap into the base. Make sure that the universal joint is angled upward.

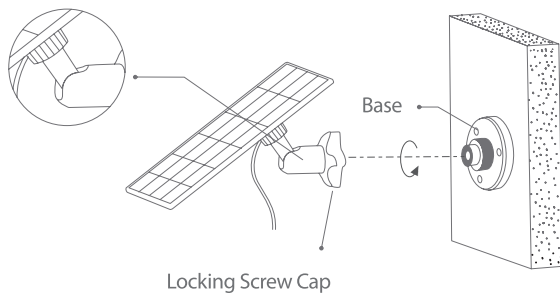

5. When adjusting the solar panel left or right, loosen the locking screw cap, turn the sleeve rod, and tighten the locking screw cap when the panel is in position.

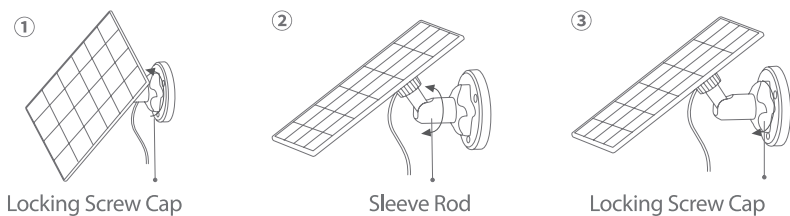

6. Solar panel's angle can be adjusted up and down up to 90°.

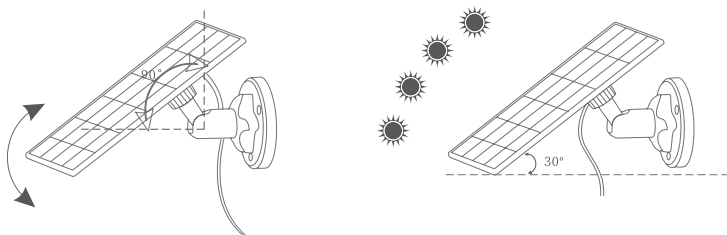

Tip: After the installation is complete, please check that all locking mechanisms are tightly secured.

Warranty & Liability

- 1 PSA Products Pty Ltd (ABN: 99 076 468 703) of 17 Millicent Street, Burwood 3125 Victoria, Australia warrants this product for a period of one year from the date of purchase, as reflected on the Authorised Resellers or Distributors invoice/ receipt provided to you. PSA Products Pty Ltd will repair or replace the product (at the option of PSA Products) due to any manufacturing defect, at the cost of PSA Products Pty Ltd (excluding any labour costs relating to removal or re-installation of product, and transport costs).
- 2 This warranty shall not apply to the product if it has been damaged, modified, abused or altered after the date of purchase, or if it fails to operate due to improper maintenance.
- 3 To the extent permitted by law, the liability of PSA Products Pty Ltd arising from the sale or under the terms of this limited warranty shall not in any case exceed the cost of replacement and subject to this clause. In no case shall PSA Products Pty Ltd be liable for consequential loss or damages resulting from the failure of the product or breach of this, or: Any other warranty, express or implied, loss or damage caused by failure to abide by the instructions supplied in the leaflets.
- 4 To the extent permitted by law, PSA Products Pty Ltd., makes no warranty, expressed or implied, written or oral, including that of merchantability or fitness for any particular purpose, with respect to the consumer replaceable battery if any. A product with non-serviceable built-in battery is covered under warranty of the product as per point 1.
- 5 This warranty is provided in addition to other rights and remedies you have under law: Our goods come with guarantees that cannot be excluded under the Australian Consumer Law. You are entitled to a replacement or refund for a major failure and compensation for any other reasonably foreseeable loss or damage. You are also entitled to have the goods repaired or replaced if the goods fail to be of acceptable quality and the failure does not amount to a major failure. What constitutes a major failure is set out in the Australian Consumer Law.
- 6 To make a claim under warranty, take the product (with a proof of purchase) to the store where you purchased the product or contact PSA Products Pty Ltd. Phone (03) 9888 9889. or Email: enquiry@psaproducts.com.au with details, proof of purchase or expense claim in writing.

Specifications

AI Feature	Human Detection, Motion Detection, Human Tracking
Resolution and FPS	3MP, 2304*1296, 15FPS
Power Supply	Battery and Solar-Power
WiFi Band	2.4GHz
FOV	100°*83°*45°
Installation Height	2.5m-3m
PIR Distance	10m
Night Vision Mode	IR+LED light
IR distance	8m
WiFi Signal Range	Open Space 100m
2-Way Communication Distance	6m
Weatherproof Rating	IP65
Battery	5000mAh
Battery Life	Solar-Powered with Unlimited Endurance
Working Temperature	-10 - 55°C
Battery Charging Temperature	>0°C
Solar Panel Working Temperature	-10 - 50°C
Charge Port	Type-C
Adapter	5V/1A&2A
Solar Panel Power	3W
Storage	SD Card Storage + Cloud Storage (subscription)
Recording Mode	Event Recording
Alarm	Sound and Light alarm
Event Types	Human Body Alarm, Motion Alarm
Storage- SD card type	FAT32, exFAT up to 128GB
Alexa & Google Assistant	Support
Audio & Video recording	Support
PT	Support



This product is designed and manufactured with high quality materials and components, which can be recycled and reused.



This symbol means the product must not be discarded as household waste, and should be delivered to an appropriate collection facility for recycling. Proper disposal and recycling helps protect natural resources, human health and the environment. For more information on disposal and recycling of this product, contact your local municipality, disposal service, or the shop where you bought this product.



PSA Products Pty Ltd
17 Millicent St, Burwood,
VIC 3125 Australia

T. 1300 772 776

enquiry@psaproducts.com.au
psaproducts.com.au