

**PSA**

**Centrii**

# Video Doorbell with HomeBase

Battery or Hardwired

**Quick Setup Guide**









Model:  
CENVDB5

# Table Of Contents

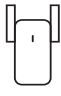
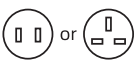
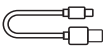
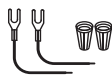
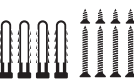
Kit Contents	2
Product Overview	3
How The System Works	6
App Installation and System Setup	11
Video Doorbell Installation	11
Notice	12
Customer Service	14

# Kit Contents

			
Video Doorbell	Mounting Bracket	15° Mounting Wedge (Optional)	Wi-Fi HomeBase
			
Wi-Fi HomeBase Power Pin	USB-C Charging Cable	Extension Wires and Wire Nuts (Optional)	Screw Packs
			
Phillips-Head Screwdriver	Quick Start Guide	Doorbell Detaching Pin	

# Product Overview

## Video Doorbell (Battery or Hardwired)

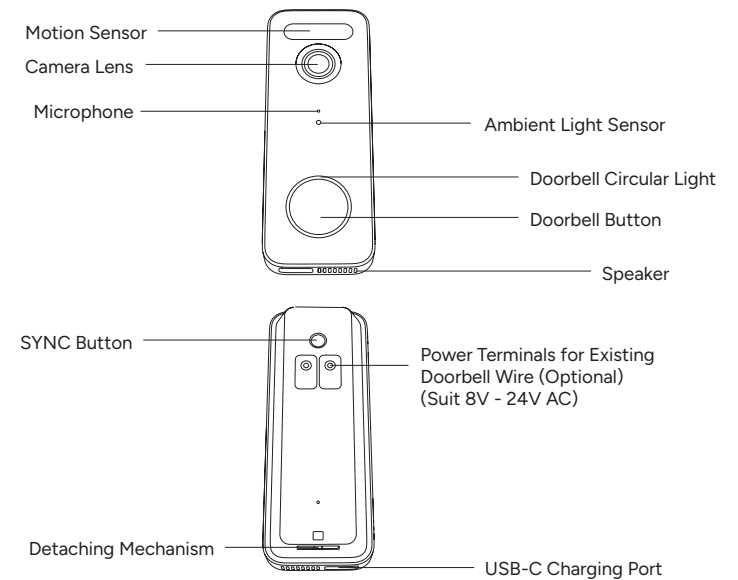

## Wi-Fi HomeBase

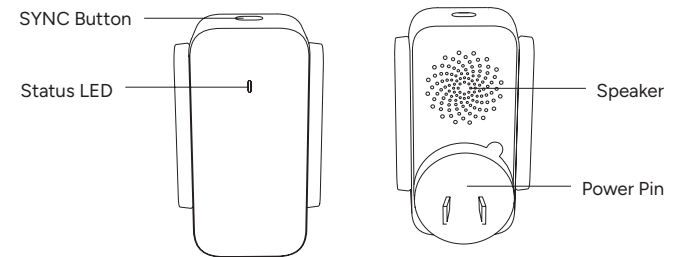

Function	Action
Turning the Doorbell ON or OFF	Press and hold the SYNC button (behind Doorbell) for 5 seconds
Reset the HomeBase ***	Press and hold the SYNC (on HomeBase) for 10 seconds (until it chirps)

\*\*\* To reset an unbound HomeBase for pairing to the PSA Centrii App.

Status LED	Meaning
Solid Green	Starting up
Blinking Green	Ready to pair with App
Solid Blue	Paired with App

# How The System Works

## What's Required for Installation

- Phillips-Head Screwdriver
- Power Drill with 1/4" (6.35mm) Drill Bit

## How the System Works

The video doorbell system comprises of 2 parts:

- The video doorbell at your door and
- The Wi-Fi HomeBase inside your house.

The video doorbell detects motion at your door and allows you to answer the door anytime and anywhere when pressed or monitored.

The Wi-Fi HomeBase acts as an internal chime and stores audio/video motion events on its built-in storage which can be played back on the PSA Centrii App.

When installing, ensure the Doorbell & Homebase is within range (up to 10m depending on building materials) for smooth operation.

**Important:** The Video Doorbell & HomeBase modules have been paired together as a unique set. DO NOT MIX WITH ITEMS FROM ANOTHER KIT.



# App Installation and Pairing the Doorbell

1. Download the PSA Centrii App from the App Store (iOS devices) or Google Play (Android devices).
2. Scan the QR code below or search "PSA Centrii" in the App Store or Google Play.

Register or log into the App. Add Wi-Fi Video Doorbell and scan the QR code for later installation process.

In the PSA Centrii app, tap "Add Device", select **Intercom** then **Video Doorbell**. Follow the step by step instructions on the PSA app to add the Video Doorbell.

## Steps:

1. Fully charge video doorbell using the USB-C charging cable.
2. Connect Homebase to 240VAC Power
3. Allow Homebase to boot up and wait for GREEN flashing LED
4. Press & Hold the SYNC button on the back of doorbell to turn it ON.
5. Wait for doorbell ring light to start flashing BLUE.
6. Connect to your home Wi-Fi
7. Use the doorbell camera to scan the QR Code on your phone to complete pairing.



# Video Doorbell Installation

## OPTION 1 - BATTERY POWERED

1. If you don't have existing doorbell wiring at the front door, please use the built-in battery. You are free to determine the doorbell position and the mounting is easy and quick.
2. When the doorbell battery level is low, you need to detach and charge it.

**Warning:** The battery life varies depending on usage. In most common cases, a doorbell may have up to 10 events per day and each recording lasts 20 seconds on average. Under this scenario, the doorbell battery life can last up to 5 months.

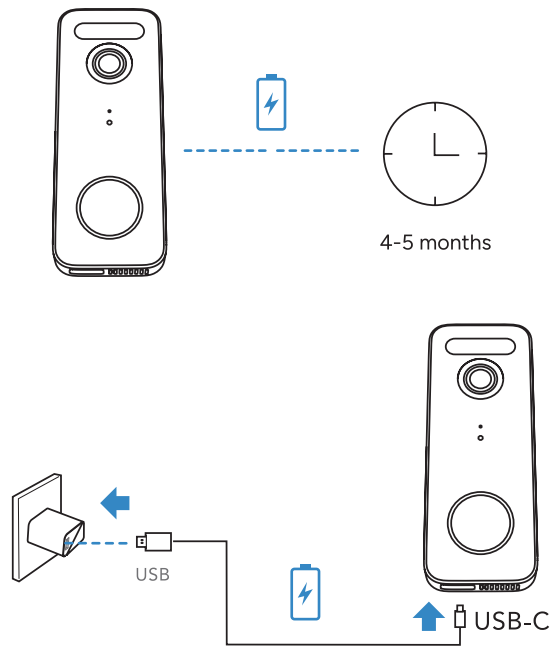

## STEP 1 - Find a Mounting Spot

Take the video doorbell to your front door and check the live view on the App at the same time. Find a location where you can get the desired field of view.

Consider the factors below:

1. Check if you can reuse the existing holes and anchors on the wall or door frame.
2. If you want to place the doorbell close to a side wall, make sure the wall doesn't show up in the field of view. Otherwise IR light will be reflected and night vision will become blurry.
3. If you drill the mounting holes for the first time, the recommended mounting height is 48" / 1.2 m from the ground.
4. Use the 15° mounting wedge as a supplementary mounting bracket if you wish to see more on a specific side. Place the Screw Hole Positioning Card against the wall to mark the position.

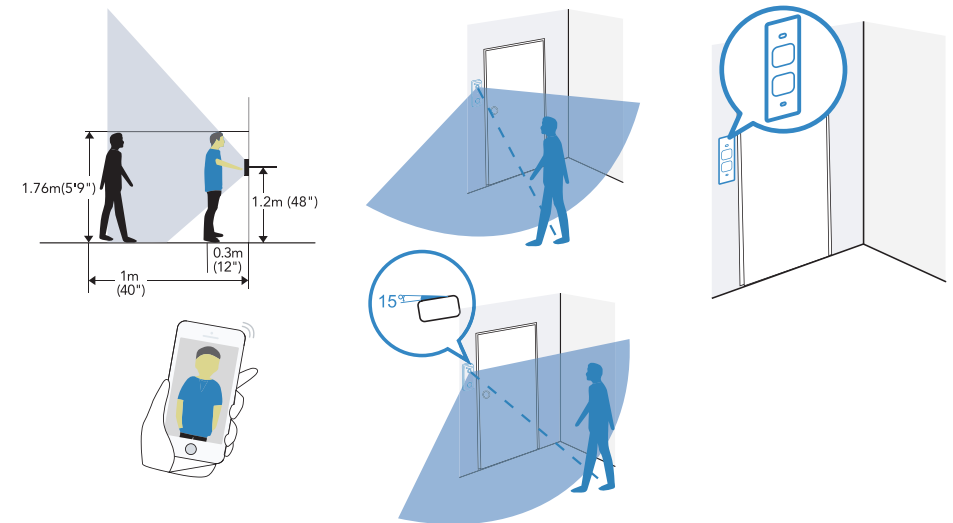

## STEP 2 - Mounting the Bracket

Mount the Doorbell on a Wooden Surface

If you mount the doorbell on a wooden surface, you don't need to pre-drill pilot holes. Use the provided screws to secure the Mounting Bracket on the wall.

The Screw Hole Positioning Card indicates the position of the screw holes.

Without 15° Mounting Wedge

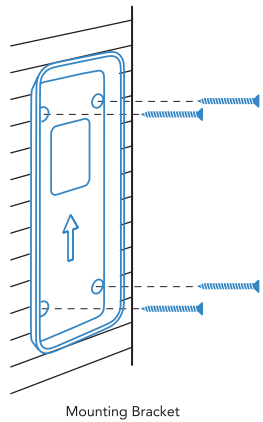

With 15° Mounting Wedge

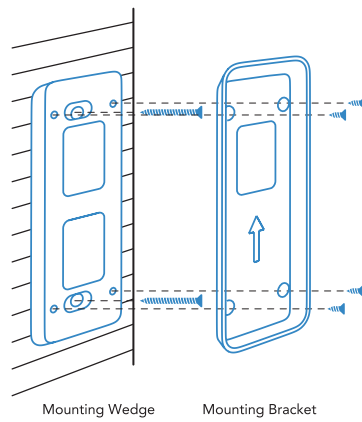

### What is required:

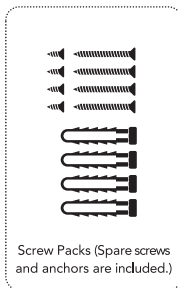
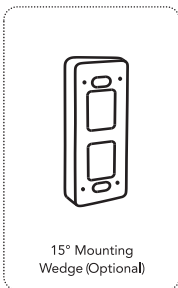
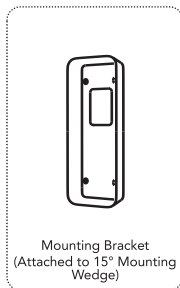
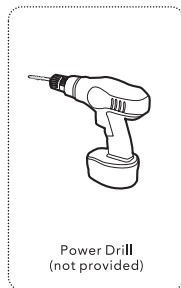

## STEP 3 - Mounting the Doorbell

Mount the Doorbell

Align the doorbell on top and then snap it on the bottom. Press it down until it clicks into place.

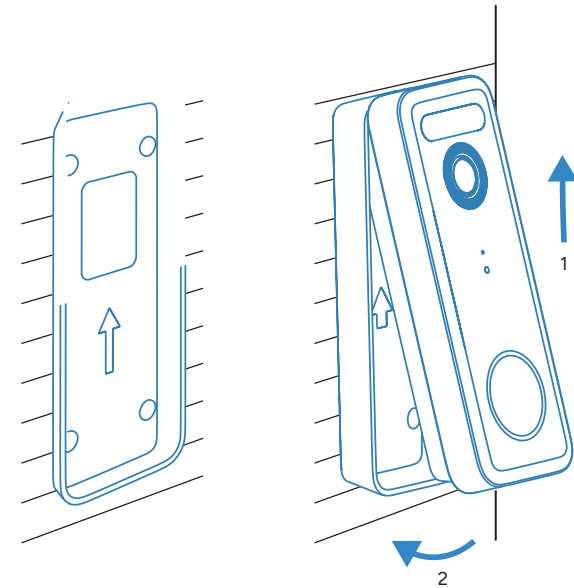

### You're all set!

If you want to detach the doorbell or recharge it, please refer to the following sections.

## Detach the Doorbell

1. Use the doorbell detaching pin provided if you wish to detach the doorbell from the Mounting Bracket.
2. Press and hold the hole on the bottom of the doorbell and then lift its bottom to take it off.

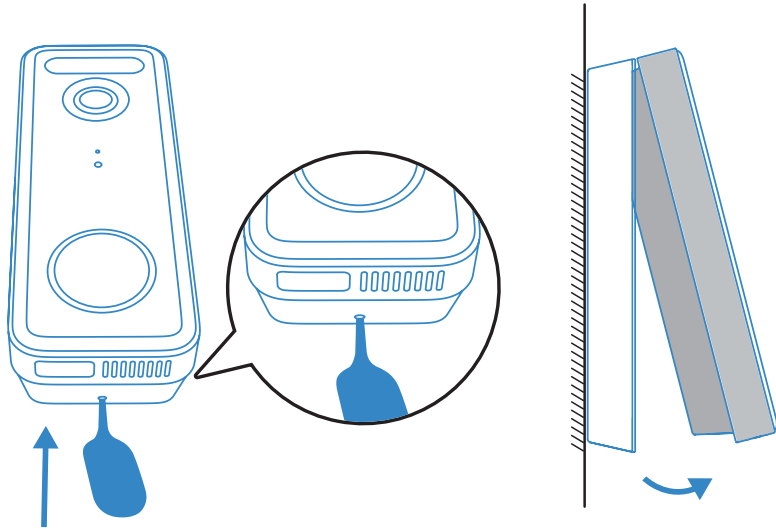

### What is required:



## Recharge the Doorbell

Status LED	Meaning
LED indication	Charging: The blue light flashes
	Fully charged: Solid blue
Charging time	6 hours from 0% to 100%

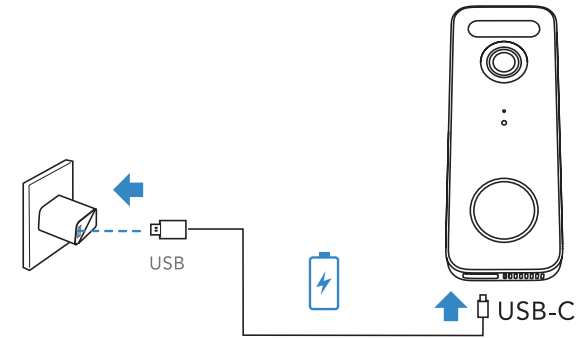

## Option 2 - Hardwired

This doorbell can be powered by an 8-24VAC power supply. Mount the bracket as shown in Step 2, connect the wires and mount the doorbell

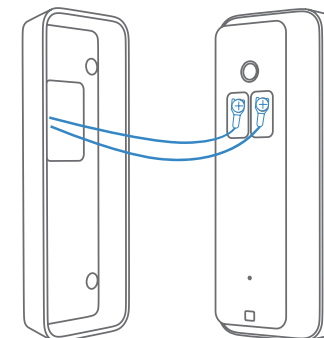

## Warranty & Liability

---

- 1 PSA Products Pty Ltd (ABN: 99 076 468 703) of 17 Millicent Street, Burwood 3125 Victoria, Australia warrants this product for a period of one year from the date of purchase, as reflected on the Authorised Resellers or Distributors invoice/ receipt provided to you. PSA Products Pty Ltd will repair or replace the product (at the option of PSA Products) due to any manufacturing defect, at the cost of PSA Products Pty Ltd (excluding any labour costs relating to removal or re-installation of product, and transport costs).
- 2 This warranty shall not apply to the product if it has been damaged, modified, abused or altered after the date of purchase, or if it fails to operate due to improper maintenance.
- 3 To the extent permitted by law, the liability of PSA Products Pty Ltd arising from the sale or under the terms of this limited warranty shall not in any case exceed the cost of replacement and subject to this clause. In no case shall PSA Products Pty Ltd be liable for consequential loss or damages resulting from the failure of the product or breach of this, or: Any other warranty, express or implied, loss or damage caused by failure to abide by the instructions supplied in the leaflets.
- 4 To the extent permitted by law, PSA Products Pty Ltd., makes no warranty, expressed or implied, written or oral, including that of merchantability or fitness for any particular purpose, with respect to the consumer replaceable battery if any. A product with non-serviceable built-in battery is covered under warranty of the product as per point 1.
- 5 This warranty is provided in addition to other rights and remedies you have under law: Our goods come with guarantees that cannot be excluded under the Australian Consumer Law. You are entitled to a replacement or refund for a major failure and compensation for any other reasonably foreseeable loss or damage. You are also entitled to have the goods repaired or replaced if the goods fail to be of acceptable quality and the failure does not amount to a major failure. What constitutes a major failure is set out in the Australian Consumer Law.
- 6 To make a claim under warranty, take the product (with a proof of purchase) to the store where you purchased the product or contact PSA Products Pty Ltd. Phone (03) 9888 9889. or Email: [enquiry@psaproducts.com.au](mailto:enquiry@psaproducts.com.au) with details, proof of purchase or expense claim in writing.

# Specifications

## Specifications

<b>Camera</b>	Image Sensor	1/2.7" 5 Megapixel CMOS
	Effective Pixels	2560(H) x 1920(V)
	IR Distance	Night visibility up to 5m
	FOV (H/V/D)	133°/103°/166°
<b>Network</b>	Wi-Fi	2.4GHz & 5GHz WiFi (IEEE802.11 b/g/n/ac)
<b>Video &amp; Audio</b>	Frame Rate	15 FPS
	Audio Input/Output	Built-in mic/Speaker
<b>Battery &amp; Microwave</b>	Capacity	5200mAh Rechargeable Li batteries
	Stand-by Time	9 months
	Working Time	5 months (30 times wake up per day)
	Radar Detection Range	Max. 8m
<b>General</b>	Alarm Trigger	Human / Radar / Motion / PIR Dectection
	Operating Temperature	-10 °C to 55 °C
	Waterproof	IP66
	Power Supply	DC 5V/1A & 2A, AC 12~24V
	Storage	Built-in 8GB Memory in HomeBase, Cloud storage
<b>HomeBase</b>	Wi-Fi Operating Frequency Range	2412~2472MHz
	Wi-Fi Max Output Power	17.13dBm(EIRP)
	Wi-Fi Operating Frequency Range	5150MHz ~ 5850MHz
	Wifi Max Output Power	13.7dBm(EIRP)
<b>Video Doorbell</b>	Wi-Fi Operating Frequency Range	2412~2472MHz
	Wi-Fi Max Output Power	18.30 dBm
<b>Warranty</b>	12-month limited warranty. The actual warranty period shall be implemented according to the requirements of local laws and regulations	



This product is designed and manufactured with high quality materials and components, which can be recycled and reused.



This symbol means the product must not be discarded as household waste, and should be delivered to an appropriate collection facility for recycling. Proper disposal and recycling helps protect natural resources, human health and the environment. For more information on disposal and recycling of this product, contact your local municipality, disposal service, or the shop where you bought this product



### Battery warning

- Replacement of a battery with an incorrect type that can defeat a safeguard (for example, in the case of some lithium battery types).
- Disposal of a battery into fire or a hot oven, or mechanically crushing or cutting of a battery, that can result in an explosion.
- Leaving a battery in an extremely high temperature surrounding environment that can result in an explosion or the leakage of flammable liquid or gas.
- A battery subjected to extremely low air pressure that may result in an explosion or the leakage of flammable liquid or gas.

**PSA**

PSA Products Pty Ltd  
17 Millicent St, Burwood,  
VIC 3125 Australia

T. 1300 772 776

[enquiry@psaproducts.com.au](mailto:enquiry@psaproducts.com.au)  
[psaproducts.com.au](http://psaproducts.com.au)