



Wireless Door/Window Contact

DWC-102

User Manual



Introduction

The DWC-102 is a Door/Window Contact that can be installed on doors, windows, and any other objects that open and close. The sensor transmits signals to the control panel when a magnet mounted near the sensor is moved away. It will also transmit alert signal to the control panel in case of low battery. The tamper protection ensures that sabotage attempts to move the contact will result in an alarm activation.

Product Overview

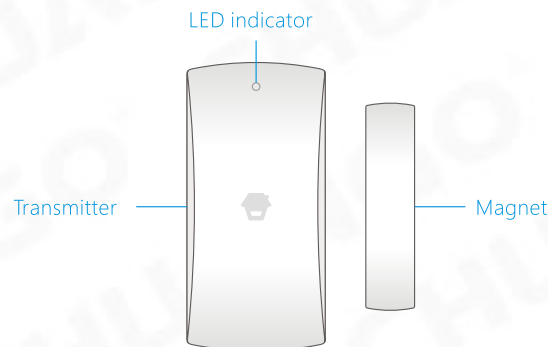

Specifications

Power supply	DC 1.5V (AA 1.5V LR6 Battery x 1 pc)		
Static current	≤ 35uA	Alarm current	≤ 10mA
Transmitting distance	≤80m (in open area)		
Radio frequency	315MHz/433.92MHz (±75KHz)		
Housing material	ABS plastic		
Operating temperature	-10°C~+55°C		
Relative humidity	≤80% (non-condensing)		
Transmitter dimensions (LxWxH)	71 x 34 x 17.5mm		
Magnet dimensions (LxWxH)	51 x 12 x 13.5mm		

PCB Layout

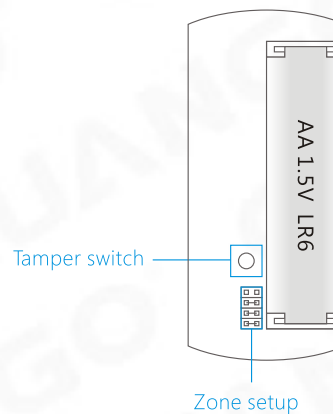

NOTE: Tamper will be triggered no matter the door/window contact is armed or disarmed.

LED Indication

LED flashes once: Door/window is opened and transmitter sends signal to the control panel.

Flash once per 3 seconds: Low power indication, please change battery as soon as possible. (User will get alert SMS about the low battery if the door contact is connected to the GSM alarm system.)

Installation & Notice

- Open the case and remove the battery activation strip.
- Mount the sensor on the door frame and the magnet on the door.
Make sure the magnet is on the right side of the transmitter. Place the transmitter in the desired location, mount the magnet no more than 1cm away from the transmitter and secure the transmitter and magnet with double-sided tapes or screws.
- Avoid mounting sensors in areas with a large quantity of metal or electrical wiring, such as a furnace or utility room.

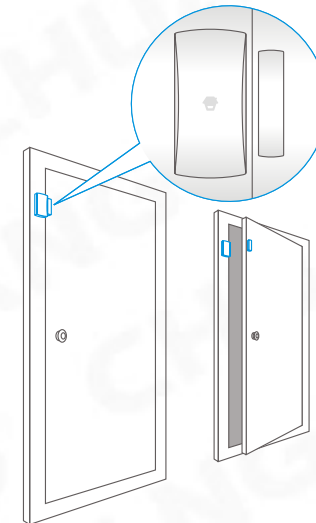

CHUANGO®

产品型号	DWC-102	部件名称	说明书
设计	林寿	材料	80克书写纸
印刷尺寸	285X210mm	成品尺寸	95X70mm
工艺	折页	版本	Ver: DWC-102-EN-1406-V5.0
<p>注: 双色、单面印刷 角线折法，顺序为绿、蓝。保持产品名称在最上面</p>			