

IntelLink NVR QUICK SETUP GUIDE

(for 4, 8 & 16-channel NVR)

INTRODUCTION

Welcome to your new IntelLink CCTV system with a 4, 8 or 16-channel NVR.

This Quick Setup Guide takes you through the initial setup of your IntelLink NVR console.

It also prepares the NVR for remote access by your IntelLink App.

STEP 1 DEVICE INSTALLATION

Plug all available cameras into the rear PoE camera ports.

Connect a CAT5 / CAT6 Ethernet cable between the LAN port of the NVR and your modem. Ensure your modem/router is ONLINE and connected to the Internet.

Connect a HDMI cable between the NVR and a TV/Monitor HDMI-input.

Connect the power cable from the supplied power supply to the "DC 48V" socket. Turn the power switch ON.

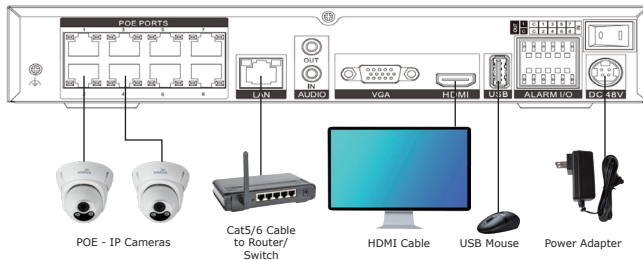

STEP 2 SYSTEM PASSWORD

- Enter your preferred login Password for your NVR. Please observe the password rules as shown on screen.

Tip: Click the eyelid-icon to reveal your Password.

- Re-enter the Password to confirm.
- Click "OK" when done.

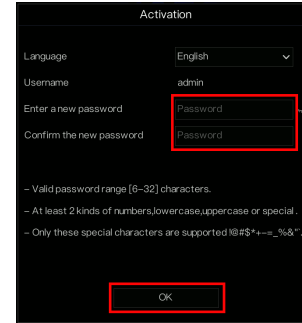

STEP 3 UNLOCK PATTERN

- Draw an Unlock Pattern by connecting at least two dots. (This pattern allows quick login without typing in the Password)
- Re-draw the Unlock Pattern to confirm. Click "OK" to continue.

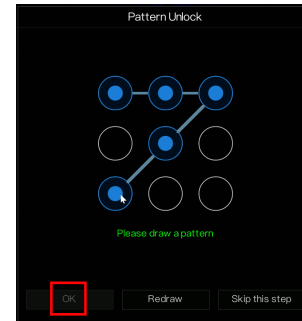

STEP 4 PASSWORD RECOVERY EMAIL

- Enter an optional Email Address for recovery passwords to be sent to. (This feature allows a lost password to be quickly reset) (Or click "Skip This Step" to bypass this feature)
- Click "OK" when done.
- Complete the three Security Questions.
- Click "OK" when done.

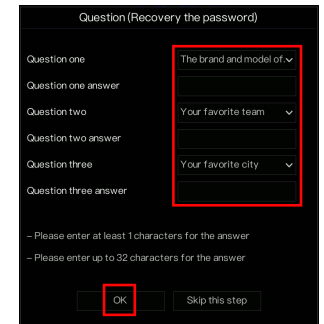
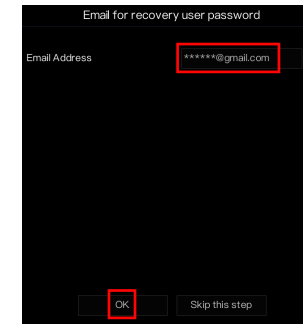

STEP 5 SETUP WIZARD

- Click "Setup Wizard" to continue with general setup.

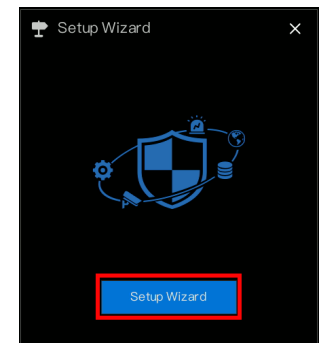

IntelLink NVR QUICK SETUP GUIDE

(for 4, 8 & 16-channel NVR)

STEP 6 NETWORK SETUP

- Confirm the **"DHCP"** switch is turned On (blue)
- Confirm **"Obtain DNS Automatically"** is On (blue)
- Click **"Next"** to continue.

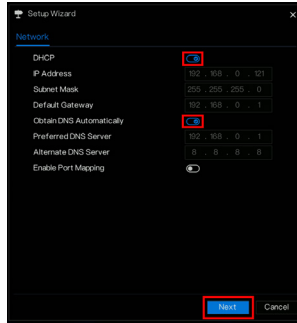

STEP 8 CAMERAS

- By now, all the cameras may already be visible in the background LiveView screen.
- Otherwise, click **"Start Search"** to look for available cameras.
- When all cameras are listed, click **"Next"** to continue.

Tip: The default camera activation password ("admin") is revealed by clicking the nearby "eye"-icon.



STEP 10 DISPLAY RESOLUTION

- Confirm the display resolution as default 1920 x 1080 pixels.

Warning: Incompatible display resolutions will cause the display to blank out.

- Click **'Finish'** to exit setup Wizard.

=====
Congratulations! You have successfully setup of your new IntelLink NVR.

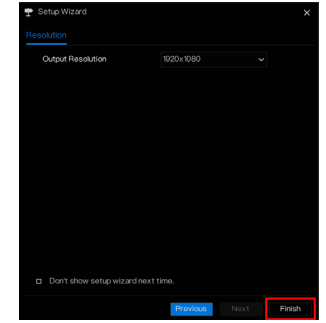

STEP 7 DATE & TIME

- Confirm **"Enable NTP"** is On (blue). This allows automatic time synchronisation via the Internet.
- Click on **"Time Zone"** tab. Then click the downward arrow to select your time zone.
- Click **"Next"** when done.

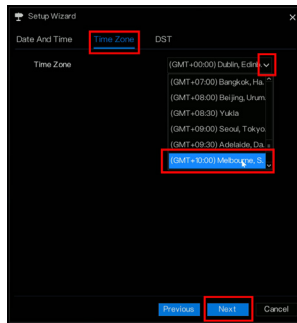
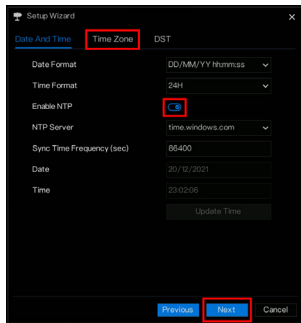

STEP 9 INITIALISE HARD DRIVE

- Click the checkbox in leftmost column to select Hard Drive to format.
- Click **"Format"** to initialise Hard Drive.
- Click **"OK"** to confirm.

Warning: This action will wipe all previously stored content in the Hard Drive.

- Click **"OK"** to continue.

