

Quick Start Guide

LIFWMB2 Interlink Network Setup

Please Read All Instructions First!

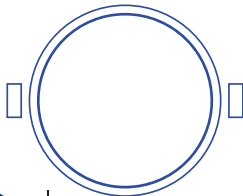

LIFESAVER



1208-7204-00

Section 1

Quick Start RF Interlink Network Setup

Section 2

**Adding a Device to an Existing
RF Interlink Network**

Section 3

Resetting a Device

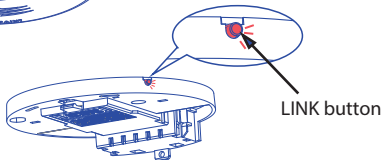
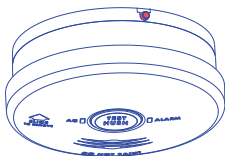

1

Power Up ONE Device

Connect one smoke alarm to the LIFWMB2 RF baseplate.

Baseplate LINK button Red LED will flash on/off every second.

Push button twice

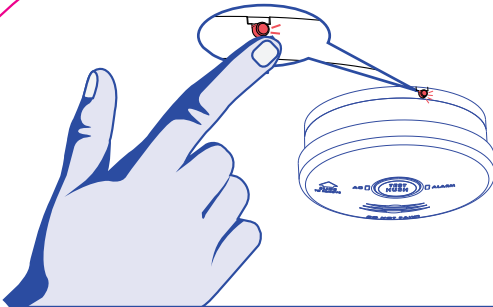

2

On the **First** Powered Device

Push the LINK button two times on the first powered device.

2 Red LED flashes every 2 seconds .
This is the network coordinator.
Join Mode is open.

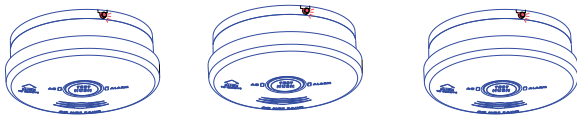

3

Power up Remaining Devices

**Power up all of the remaining RF baseplates
by connecting them completely
on the smoke alarm.**

Red LED flashes 3 times
every 2 seconds after
joining the network.

Push button twice

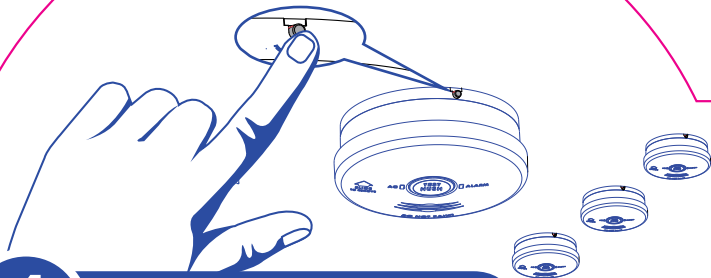

4

Pick Any Device

Push the LINK button twice on any unit after all the smoke alarms have joined the network.

Red LED stops flashing on each unit as network is closed.

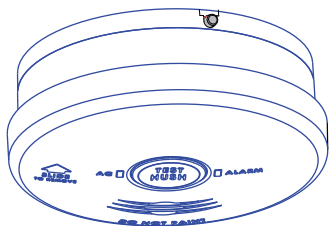

5 Setup Complete!

If all devices are no longer flashing the Red LED, the devices are now connected.

Congratulations!

Refer to user guide for detailed installation instructions.

Section 2

Adding a Device to an Existing RF Interlink Network

Push button twice

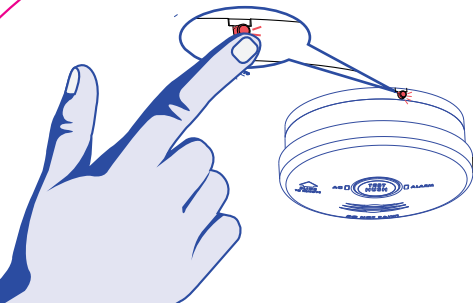

1

Push LINK Button Twice on any installed unit.

**To open the RF Interlink Network,
push the LINK button twice on any
previously connected smoke alarm**

Red LED flashes every 2 seconds.
Join Mode is open.

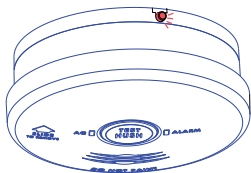

2

Power On the New Device(s)

Connect the smoke alarm to the new RF baseplate.

Red LED flashes 3 times every 2 seconds after joining the network.

Push button twice

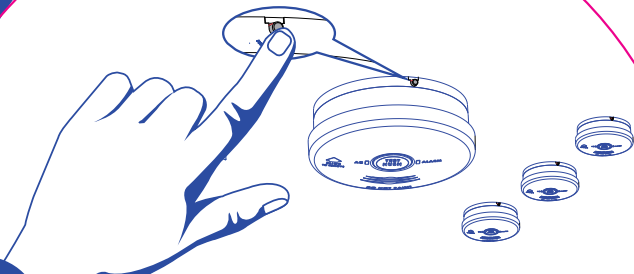

3

Choose **ANY** Connected Device

Push LINK button twice on any connected device to close the network.

Red LED stops flashing on each unit as network is closed.

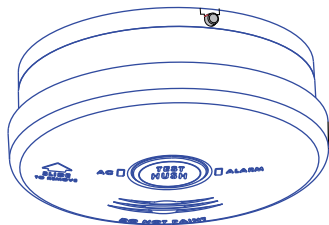

4 Setup Complete!

If all devices are no longer flashing the Red LED, the devices are now connected.

Congratulations!

Refer to user guide for detailed installation instructions.

Section 3

Resetting Your Device

If you encounter an issue at any point during the RF Interlink network setup process, or if you need to remove a device from a network, you may reset the device by following the subsequent directions.

Push button twice

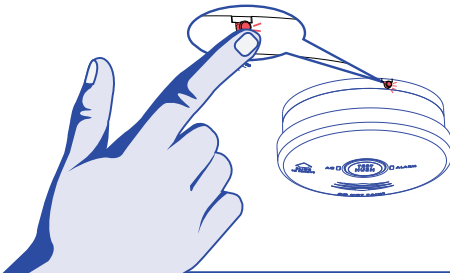

1

Resetting the Device

Push LINK button twice to open Join Mode. Unit will respond with 2 or 3 flashes, indicating Coordinator or RFD respectively.

Push and hold button

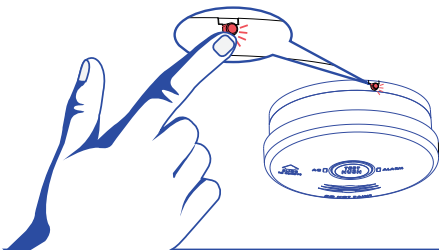

2

Resetting the Device

Press and Hold button for 4 to 5 seconds. Unit will respond with 4 quick flashes indicating that the wireless settings have been reset and the unit is now a standalone alarm.

Device has been put in General Reset Condition.

See User Guide for complete instructions on how to return to a network

Need more help
getting started?

Visit www.psaproducts.com.au
to view video tutorials.



*PSA Products also supply your
intercom and security requirements.*

*Consult the User Guide for more detailed
instructions on product installation and use.*